



## MYM SERIES RESOLVERS

## MYM-08

### Features:

- Hollow shaft ID: 4 mm
- Outer diameter: 20.32 mm
- Length: 18 mm



### ELECTRICAL DATA

MDS.MYM-08-1P-A01R	
Primary Side	R1-R2
Pole pairs	1
Transformation ratio	0.5±10%
Input Voltage	7 Vrms – (5Vrms)
Input Current	65 mA – (47mA)
Input frequency	10 kHz
Phase shift	-20° ± 2°
Null Voltage	30mVmax
Zro	68+95j Ω
Zrs	66+84j Ω
Zso	94+250Ω
Zss	92+225j Ω
R1-R2 DC resistance	50 Ω ± 10% (@20°C)
Stator DC resistance	32 Ω ± 10% (@20°C)
Accuracy	±10'
Operating temp.	-50°C / +155°C

### SCHEMATIC and TECHNICAL DRAWINGS

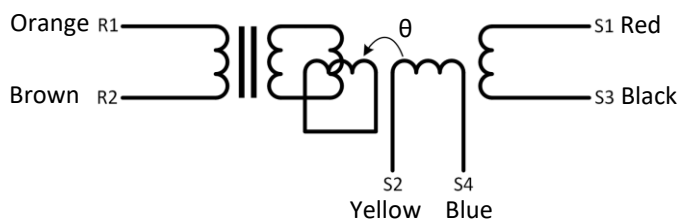

**Input:**  $E(R1-R2) = E \sin(\omega t)$

**Output:**  $E(S1-S3) = Tr \times E(R1-R2) \cos\theta$   
 $E(S2-S4) = Tr \times E(R1-R2) \sin\theta$

**Tr:** Transformation ratio

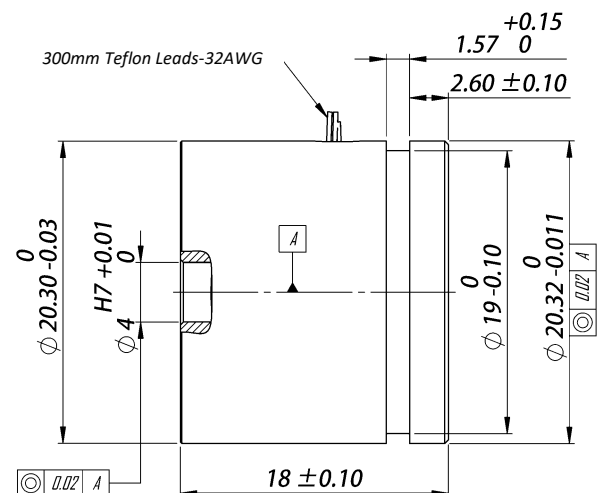

Rev-6	27.03.2023	M.Onsal	T.5.5 ve S.5.5 revizyonu
Rev-7	16.10.2023	M.Onsal	S.5.5 revizyonu